



Parts Catalog

John Deere 38 Front Blade

PC-1310



For your convenience,
three postage-paid mailing
cards are provided to re-
port an error or convey a
suggestion relative to
John Deere Service
Publications.



JOHN DEERE SERVICE PUBLICATIONS REPORT

Publication No. _____ Pub. Date _____ Page _____

Machine _____ ☐ Report of Error ☐ Suggestion

Name _____ Company _____

Address _____

City and State _____ Date _____

JOHN DEERE SERVICE PUBLICATIONS REPORT

Publication No. _____ Pub. Date _____ Page _____

Machine _____ ☐ Report of Error ☐ Suggestion

Name _____ Company _____

Address _____

City and State _____ Date _____

JOHN DEERE SERVICE PUBLICATIONS REPORT

Publication No. _____ Pub. Date _____ Page _____

Machine _____ ☐ Report of Error ☐ Suggestion

Name _____ Company _____

Address _____

City and State _____ Date _____

Postage
Will be Paid
by
Addressee

No
Postage Stamp
Necessary
If Mailed in the
United States

BUSINESS REPLY CARD

First-Class Permit No. 8, Moline, Illinois 61265

DEERE & CO.

John Deere Road
Moline, Illinois 61265

Service Publications Dept.



Postage
Will be Paid
by
Addressee

No
Postage Stamp
Necessary
If Mailed in the
United States

BUSINESS REPLY CARD

First-Class Permit No. 8, Moline, Illinois 61265

DEERE & CO.

John Deere Road
Moline, Illinois 61265

Service Publications Dept.



Postage
Will be Paid
by
Addressee

No
Postage Stamp
Necessary
If Mailed in the
United States

BUSINESS REPLY CARD

First-Class Permit No. 8, Moline, Illinois 61265

DEERE & CO.

John Deere Road
Moline, Illinois 61265

Service Publications Dept.

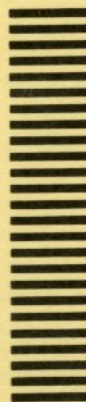



M11068

John Deere 38 Front Blade

EXPLANATION OF SERIAL NUMBER OR YEAR LISTING

Serial number information is listed parenthetically to show on which machines each part can be used. These listings are explained by the following examples.

- (-) The part can be used on all machines.
- (000000-) The part can be used on all machines beginning with the serial number listed.
- (-000000) The part can be used on all machines up to and including serial number listed.
- (000000-000000) The part can be used on all machines between and including the serial numbers listed.

Where XXXXXX's are listed in place of a serial number it indicates a serial number change was made but the exact serial number had not been established when the catalog went to press.

AN EXPLANATION OF CHANGE INDICATOR LINE

New and revised information is identified by vertical lines marked on the left-hand margin of revised pages. These lines indicate changes affecting the ordering of parts.

SI (INTERNATIONAL SYSTEM) UNITS OF MEASURE

Metric equivalents have been included, where applicable, throughout this parts catalog.

(Specifications and design subject to change without notice)

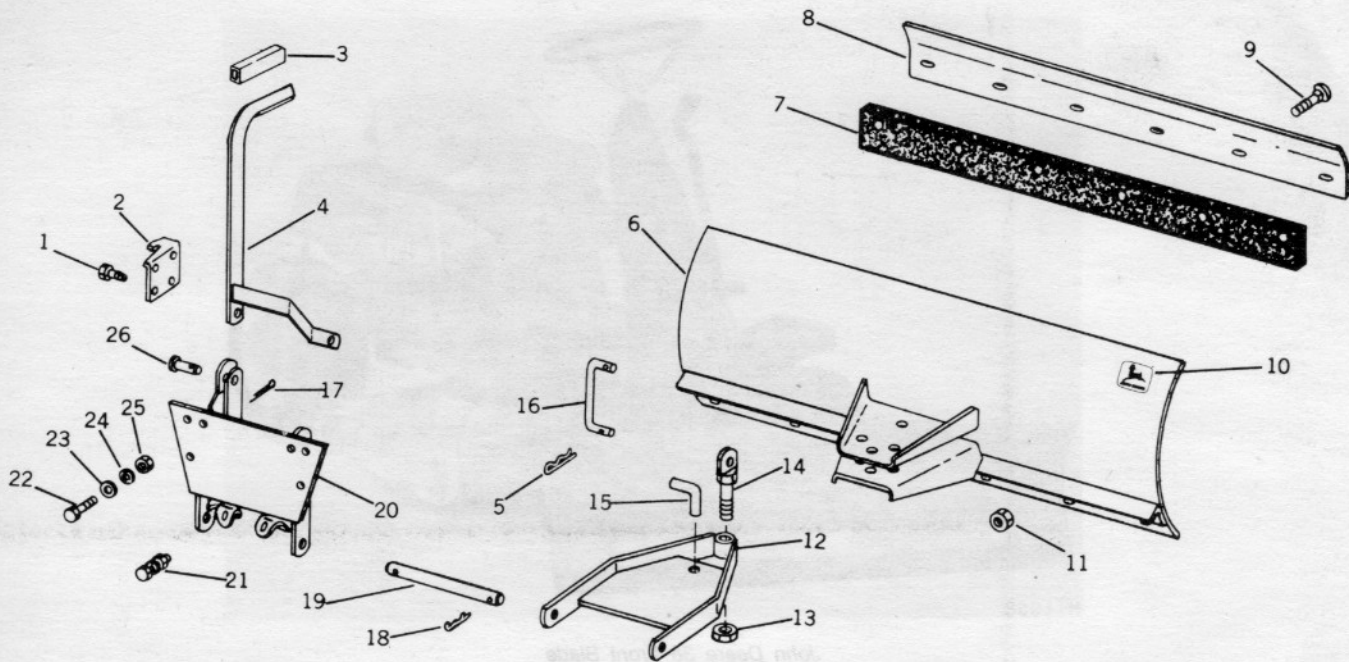

M11069

| KEY | PART NO. | SERIAL NO. | DESCRIPTION |
|-----|----------|------------|---|
| 1 | 37H 49 | (-) | SCREW, SELF-TAPPING, NO. 10 X 1/2" (4USED) |
| 2 | M 46561 | (-) | LATCH |
| 3 | F 2948 R | (-) | GRIP, HANDLE |
| 4 | AM 34069 | (-) | LEVER, LIFT |
| 5 | J 16931 | (-) | PIN, SPRING LOCKING (2 USED) |
| 6 | AM 34070 | (-) | BLADE |
| 7 | M 46560 | (-) | SQUEEGEE, BLADE |
| 8 | M 46557 | (-) | STRAP, BLADE |
| 9 | 3H 2126 | (-) | BOLT, RD. HD., 5/16" X 1-1/8" (6 USED) |
| 10 | JD 5273 | (-) | DECAL, "LEAPING DEER" |
| 11 | M 63277 | (-) | NUT, LOCK, 5/16" (6 USED) |
| 12 | AM 34068 | (-) | LIFT |
| 13 | B 14441 | (-) | NUT, LOCK, 1/2" |
| 14 | AM 34066 | (-) | BOLT, LIFT |
| 15 | M 41665 | (-) | PIN, PIVOT LOCK |
| 16 | M 46549 | (-) | ROD, LIFT |
| 17 | 11H 278 | (-) | PIN, COTTER, 7/64" X 3/4" |
| 18 | M 40461 | (-) | PIN, SPRING LOCKING (2 USED) |
| 19 | M 46548 | (-) | PIN, MOUNTING |
| 20 | AM 34067 | (-) | PLATE, MOUNTING |
| 21 | 19H 1732 | (-) | SCREW, CAP, 3/8" X 1-1/4" (2 USED) |
| | 19H 1731 | (-) | SCREW, CAP, 3/8" X 1" (2 USED) (55 MOWER) |
| | 12H 304 | (-) | WASHER, LOCK, 3/8" (2 USED) (55 MOWER ONLY) |
| | 14H 812 | (-) | NUT, 3/8" (2 USED) (55 MOWER ONLY) |
| 22 | 19H 1900 | (-) | SCREW, CAP, 5/16" X 3/4" (4 USED) |
| 23 | 24H 1887 | (-) | WASHER, 11/32" X 1" X 0.134" (4 USED) |
| 24 | 12H 303 | (-) | WASHER, LOCK, 5/16" (4 USED) |
| 25 | 14H 785 | (-) | NUT, 5/16" (4 USED) |
| 26 | M 40569 | (-) | PIN, DRILLED, 3/8" X 1" |