



# Electrak<sup>®</sup>

## Garden Tractor

### 42" ROTARY MOWER For Rear or Side Discharge

#### REAR DISCHARGE MOWER KIT INSTALLATION

Assemble the mower and kit components as shown in Figure 1. Attach the baffle, side cover, clutch assemblies and blades in that order.

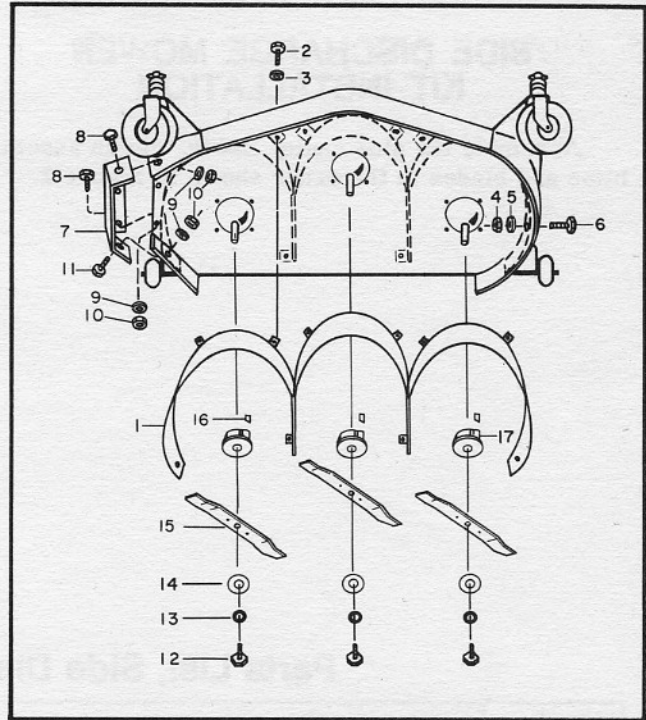

Fig. 1 Rotary Mower Rear Discharge Kit Installation

#### Parts List, Rear Discharge - Model No. R42

Ref. No.	Description	Catalog Number or Size	Qty.
1	Baffle	423D204G1	1
2	Bolt - fastening baffle to frame	1/4 - 20 - 7/8" hex hd.	8
3	Lock washer for baffle bolt	1/4"	8
4	Nut for baffle bolt (opposite chute end)	1/4 - 20" hex hd.	1
5	Lock washer baffle bolt (opposite chute end)	1/4"	1
6	Bolt fastening baffle to frame (opposite chute end)	1/4 - 20 - 5/8" hex hd.	1
7	Cover plate (closing side opening)	542C899P1	1
8	Bolt (fastening cover plate to frame, front & top)	1/4 - 20 - 5/8" hex hd.	3
9	Nut (for cover plate bolts)	1/4 - 20	4
10	Lock washer for cover plate bolts	1/4"	4
11	Bolt (fastening rear side cover plate to frame)	1/4 - 20 - 3/4" hex hd.	1
12	Bolt (fastening blade)	5/16 - 24 - 1 1/2" hex hd.	3
13	Lock washer for blade bolt	5/16"	3
14	Washer for blade bolt	2 1/4 O.D. 3/8 I.D. 1/8" thk.	3
15	Blade	163B9871P1	3
16	Key	163B9892P3	3
17	Clutch body	163B9891P1	3

