

# PC

## Parts Catalog

### John Deere Electric 90 Mower

PC-1279





John Deere Electric 90 Mower  
 1972 Model-Serial No. ( 1001-10,000)  
 1973 Model-Serial No. (10,001-11,704)  
 1974 Model-Serial No. (11,705- )

*(Specifications and design subject to change without notice)*

#### **AN EXPLANATION OF CHANGE INDICATOR LINE**

New and revised information is identified by vertical lines marked in the left-hand margin of revised pages. These lines indicate changes affecting the ordering of parts.

#### **AN EXPLANATION OF SERIAL NUMBER INFORMATION**

Serial number information is listed parenthetically to show on which machines each part can be used. These listings are explained by the following examples.

- ( - ) The part can be used on all machines.
- (000000- ) The part can be used on all machines beginning with the serial number listed.
- ( -000000) The part can be used on all machines up to and including serial number listed.
- (000000-000000) The part can be used on all machines between and including the serial numbers listed.

Where XXXXXX's are listed in place of a serial number it indicates a serial number change was made but the exact serial number had not been established when the catalog went to press.

#### **EXPLANATION OF PARTS LISTED AS "SERVICE ONLY"**

Certain parts in this catalog are listed in the description column as "Service Only." These parts serve as a replacement or additional part for service instead of the part originally furnished. The serial numbers shown list the machines on which the "Service Only" part may be used.

## ALPHABETICAL INDEX

|   | Page     |                                    | Page     |
|---|----------|------------------------------------|----------|
| A                                       |          | L                                  |          |
| Axle, front .....                       | 11       | Lever, lift .....                  | 10       |
| Axle, rear .....                        | 14       | Lever, shift .....                 | 9        |
| B                                       |          | Lift stop .....                    | 10       |
| Battery .....                           | 18       | M                                  |          |
| Belt, traction drive .....              | 5,6      | Main wiring harness .....          | 21,22,23 |
| Blades .....                            | 25,26    | Motor, mower .....                 | 25,26    |
| Box, battery .....                      | 3        | Motor, traction .....              | 24       |
| Brake .....                             | 7,8      | Mower deck .....                   | 16       |
| C                                       |          | P                                  |          |
| Cables, battery .....                   | 18       | Panel, control .....               | 4        |
| Cable, lift .....                       | 10       | R                                  |          |
| Charger, battery .....                  | 19,20    | Resistor .....                     | 21,22,23 |
| Clutch .....                            | 5,6      | Reverse idler .....                | 14       |
| Console .....                           | 3        | Rod, lift lever adjusting .....    | 10       |
| Control panel .....                     | 4        | Rods, shifter .....                | 15       |
| Countershaft gears .....                | 15       | Rollers, mower .....               | 16       |
| Cover, battery .....                    | 18       | S                                  |          |
| Cover, contactors .....                 | 4        | Seat .....                         | 4        |
| D                                       |          | Shaft, input .....                 | 13       |
| Deck, mower .....                       | 16       | Sheave, drive and driven .....     | 5,6,24   |
| Differential .....                      | 14       | Shift lever .....                  | 9        |
| Diode .....                             | 21,22,23 | Shift lever housing .....          | 9        |
| Drive sheave, traction .....            | 5,24     | Shifter forks .....                | 15       |
| Driven sheave, traction .....           | 5,6      | Shifter rods .....                 | 15       |
| F                                       |          | Shroud .....                       | 4        |
| Forks, shifter .....                    | 15       | Solenoids .....                    | 21,22,23 |
| Frame .....                             | 3        | Steering gear .....                | 11       |
| Fuse .....                              | 21,22,23 | Steering wheel .....               | 11       |
| G                                       |          | Switch, main .....                 | 21,22,23 |
| Gear case, transaxle .....              | 13       | Switch, mower .....                | 21,22,23 |
| Gears, countershaft .....               | 15       | Switch, safety-start .....         | 21,22,23 |
| Gears, drive .....                      | 14       | T                                  |          |
| Guard, chute, with decals .....         | 16       | Tire, front .....                  | 11       |
| H                                       |          | Tire, rear .....                   | 12       |
| Harness, wiring, main .....             | 21,22,23 | Traction drive belt .....          | 5,6      |
| Harness, wiring, mower motors .....     | 25,26    | Traction motor .....               | 24       |
| Hold-down, battery .....                | 18       | Transaxle gear case assembly ..... | 13       |
| Housing, shift lever .....              | 9        | W                                  |          |
| Housing, transaxle .....                | 13       | Wheel, front .....                 | 11       |
| Hub, rear wheel .....                   | 12       | Wheel, gauge, mower .....          | 16       |
| I                                       |          | Wheel, rear .....                  | 12       |
| Idler, reverse .....                    | 14       | Wheel, steering .....              | 11       |
| Input, shaft .....                      | 13       | Wiring harness, main .....         | 21,22,23 |
| K                                       |          | Wiring harness, mower motors ..... | 25,26    |
| Kit, receptacle, remote, electric ..... | 21,22,23 |                                    |          |

## FRAME, BATTERY BOX, AND CONSOLE

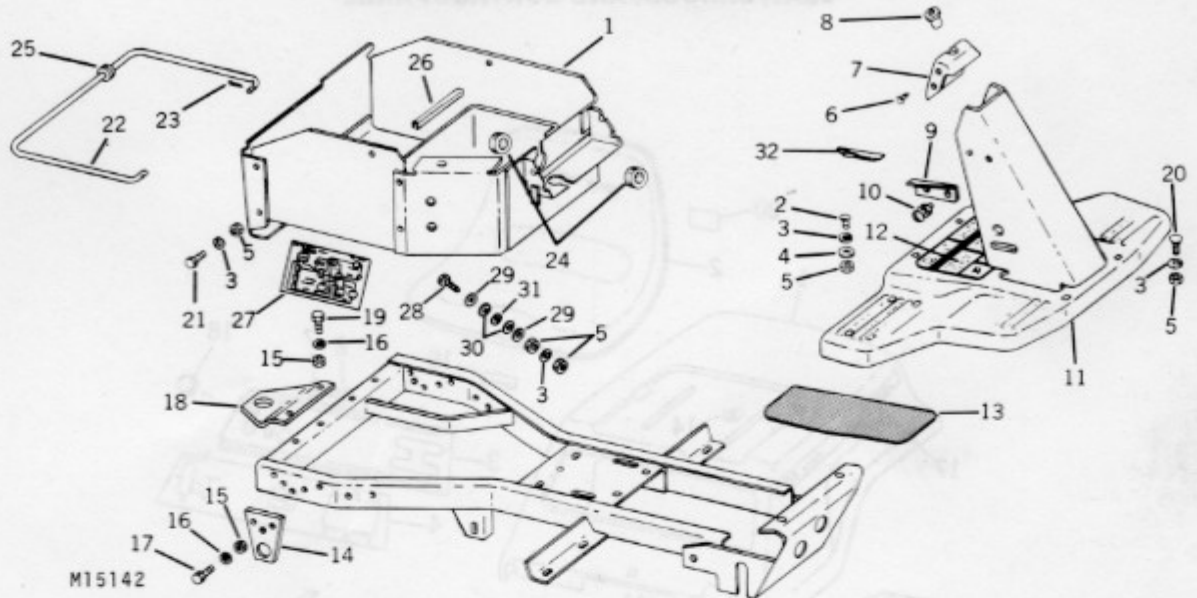

| Key | Part No. | Serial No.        | Description  |
|-----|----------|-------------------|--|
| 1   | AM 33914 | ( - 10000 )       | Box, battery   |
|     | AM 34658 | ( 10001 - 11704 ) | Box, battery   |
|     | AM 35274 | ( 11705 - )       | Box, battery   |
| 2   | 3H 1268  | ( - )             | Bolt, cge., 5/16" x 3/4" (4 used)                              |
| 3   | 12H 303  | ( - )             | Washer, lock, 5/16" (17 used)                                  |
| 4   | 24H 1136 | ( - )             | Washer, 11/32" x 11/16" x .060" (8 used)                       |
| 5   | 14H 785  | ( - )             | Nut, 5/16" (19 used)   |
| 6   | 37H 126  | ( - )             | Screw, self-tapping, No. 8 x 3/8" (3 used)                     |
| 7   | M 46433  | ( - )             | Cap, console   |
| 8   | M 45262  | ( - )             | Bushing, plastic   |
| 9   | M 46440  | ( - 11704 )       | Latch, lever   |
|     | M 48417  | ( 11705 - )       | Latch, lever   |
| 10  | 21H 1302 | ( - )             | Screw, mach., 1/4" x 5/8" (2 used)                             |
|     | 12H 302  | ( - )             | Washer, lock, 1/4"   |
| 11  | AM 33978 | ( - )             | Console  |
| 12  | M 46519  | ( - 10000 )       | Label, instruction   |
|     | M 47426  | ( 10001 - )       | Label, instruction   |
| 13  | AM 33750 | ( - )             | Kit, foot-tread (includes R.H. and L.H. treads)                |
| 14  | M 46385  | ( - )             | Support, axle, rear  |
| 15  | 14H 812  | ( - )             | Nut, 3/8" (6 used)   |
| 16  | 12H 304  | ( - )             | Washer, lock, 3/8" (6 used)                                    |
| 17  | 19H 1936 | ( - )             | Screw, cap, 3/8" (6 used)                                      |
| 18  | M 46437  | ( - )             | Plate, hitch   |
| 19  | 19H 1731 | ( - )             | Screw, cap, 3/8" x 1" (2 used)                                 |
| 20  | 3H 1539  | ( - )             | Bolt, cge., 5/16" x 5/8" (2 used)                              |
| 21  | 19H 1813 | ( - )             | Screw, cap, 5/16" x 5/8" (5 used)                              |
| 22  | M 46442  | ( - )             | Rod, support, shroud   |
| 23  | 11H 206  | ( - )             | Pin, cotter, 3/32" x 3/4" (2 used)                             |
| 24  | H 23197  | ( - 1500 )        | Grommet (2 used)   |
|     | M 44391  | ( 1501 - )        | Edging, vinyl (10 ft. long) (cut as required)                  |
| 25  | M 46796  | ( 1501 - )        | Grommet (2 used) (sub. for M46492)                             |
| 26  | M 44391  | ( - )             | Edging, vinyl (10 ft. long) (cut as required)                  |
| 27  | M 47447  | ( 10001 - 11704 ) | Decal, electric system   |
|     | M 48727  | ( 11705 - )       | Decal, electric system   |
| 28  | 19H 1905 | ( 11705 - )       | Screw, cap, 5/16" x 1" (2 used)                                |
| 29  | 24H 1224 | ( 11705 - )       | Washer, 11/32" x 1" x .060" (4 used)                           |
| 30  | M 41394  | ( 11705 - )       | Washer, fiber, 11/32" x 1" x .060" (4 used)                    |
| 31  | M 41393  | ( 11705 - )       | Washer, fiber, 11/32" x 41/64" x .060" (2 used)                |
| 32  | M 48418  | ( 11705 - )       | Decal, cutting height  |
| ..  | ..       | ( - )             | Frame (dealer contact branch service department when required) |
| ..  | AM 35067 | ( - )             | Kit, French and English decal                                  |

