

PARTS LIST AND INSTRUCTIONS

UTILITY WAGON

FACTORY ORDER NUMBER 7-2112

(Formerly 7-2111)

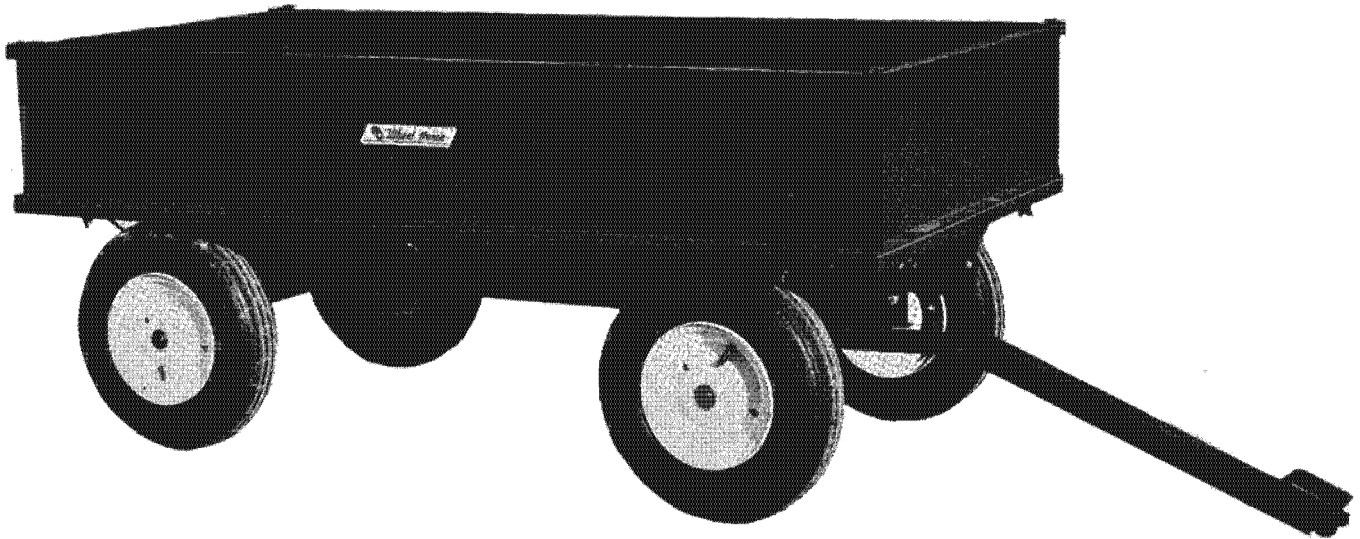

ASSEMBLY

The wagon is shipped completely packed in one carton. The wagon side and end panels have been pre-assembled to the bed using hardware conducive to good packaging and handling.

1. Remove from carton, separate and identify all loose parts. Place bed assembly **upside down** on suitable work surface.

2. Remove the lock nuts from the carriage bolts securing the side and end panels to the bed; re-insert the bolts from the opposite direction and secure with **wing** nuts. Save the lock nuts for later use.

3. Note the difference in width between the four (4) holes punched toward the center area of the bed. Examine the two bed supports noting that one channel leg of each has two holes near one end (rear). Position these ends, holes upward, at the **wide** (rear) bed hole locations with channel legs facing each other and secure supports to the bed with four carriage bolts and lock nuts. (Leave these and subsequent bolts slightly loose to ease assembly.)

4. Secure rear axle assembly (Ref. #15), positioned as shown on the exploded view drawing, through the second holes from end of bed supports with hardware provided.

5. Secure rear braces (dog-leg type Ref. #23) to rear holes in bed supports and bed.

6. Position and secure front axle assembly as shown on exploded view drawing.

7. Install front braces (Ref. #22) and draw bar assembly (Ref. #19).

8. Install the wheel assemblies, keeping the valve stem to the outside and lubricate with chassis lube. Tighten securely all bolts and nuts.

OPERATION

The load capacity of the wagon is eleven cubic feet. Weight capacity is 600 lbs.

Sides are removable for hauling bulky loads.

Sharp turns over uneven ground should be avoided when wagon is loaded to maximum capacity.

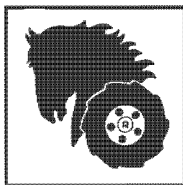

WHEEL HORSE

lawn & garden tractors

PARTS LIST — UTILITY WAGON
FACTORY ORDER NUMBER 7-2112
(FORMERLY 7-2111)

Parts available only through Authorized Dealers.
 When ordering parts always list Part No. and Description.
(Specifications subject to change without notice.)

ITEM NO.	PART NO.	DESCRIPTION	NO. REQ'D.
1	915113	Nylok Nut $\frac{3}{8}$ -16	16
2	915238	Hex. Jam Nut $\frac{1}{2}$ -13	4
3	1030	Grease Fitting	2
4	920083	Lock Washer $\frac{3}{8}$	16
5	920218	Washer (Grease Fitting)	2
6	900062	Carriage Head Bolt $\frac{3}{8}$ -16 x $\frac{3}{4}$	16
7	900066	Carriage Head Bolt $\frac{3}{8}$ -16 x $1\frac{3}{4}$	10
8	5618	E-Ring	2
9	908065	Bolt, Hex $\frac{1}{2}$ -13 x 3	1
10	915586	Wing Nut $\frac{3}{8}$ -16	10
11	1278	Shim Washer $\frac{3}{4}$ I.D.	4
12	1758	Wheel Assembly	4
13	3007	Bed	1
14	3050	Front Axle Assembly	1
15	3014	Rear Axle Assembly	1
16	3018	Side Panel	2
17	3019	End Panel	2
18	3042	Swivel Hitch Assembly	1
19	3044	Draw Bar Assembly	1
20	3032	Bed Support R.H.	1
21	3033	Bed Support L.H.	1
22	3034	Front Brace	2
23	3035	Rear Brace	2
24	3047	Tie Rod	1
25	3608	Clevis Pin	2
26	5270	Spindle Assembly R.H.	1
27	5271	Spindle Assembly L.H.	1
28	102831	Decal	2
29	915115	Nylok Nut $\frac{1}{2}$ -13	1
30	915240	Hex. Jam Nut $\frac{5}{8}$ -11	2
31	1521	Bearing (2 Per Wheel)	8
32	908033	Bolt — Nylok $\frac{3}{8}$ -16 x $\frac{7}{8}$	4
33	2844	Washer — Wheel	4
34	1760	Tire	4
35	1761	Tube	4
36	1759	Wheel	4
	*3039	Tractor Hitch Plate	1

* Not shown or included. Use with 8-5521 Slot Hitch only.

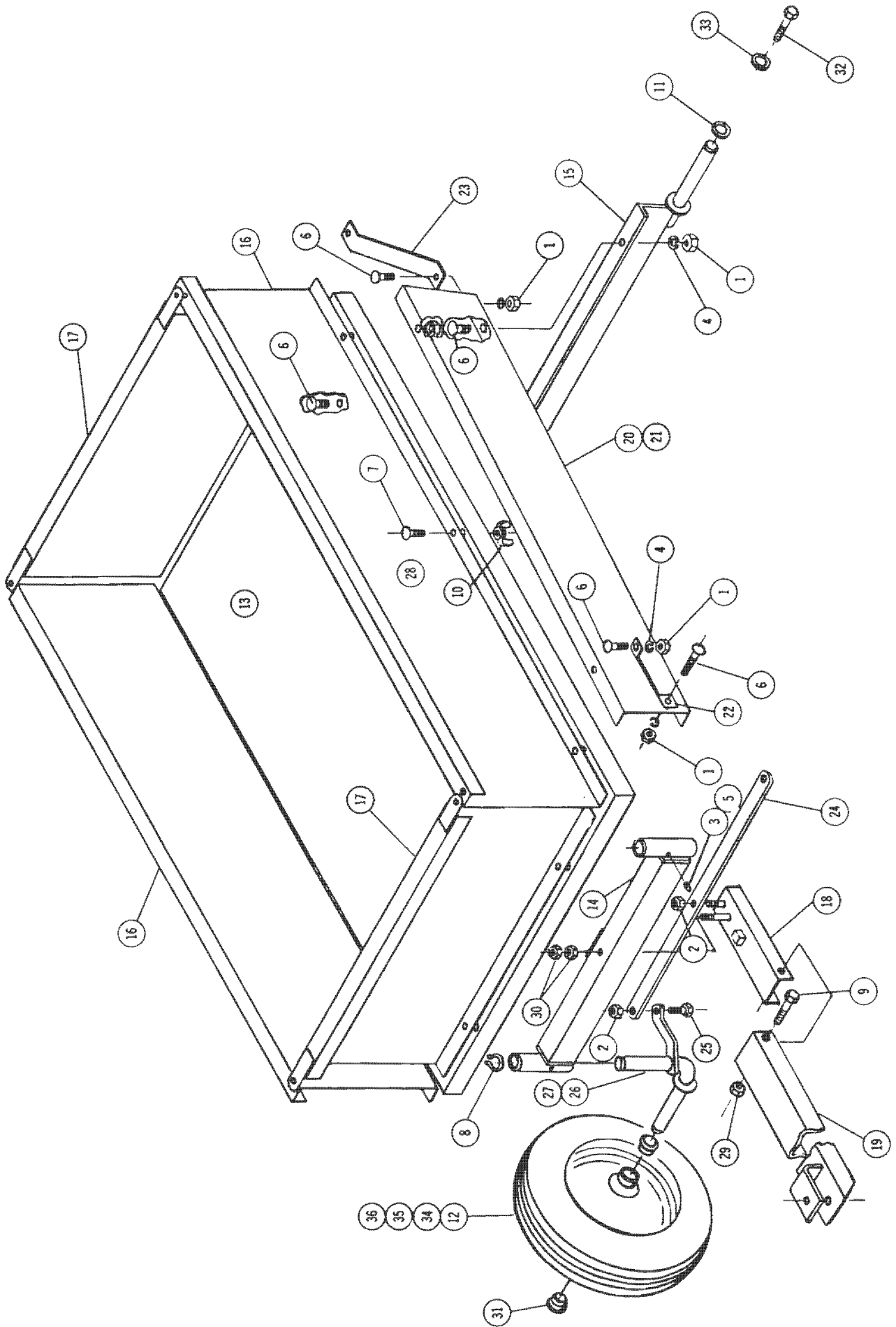

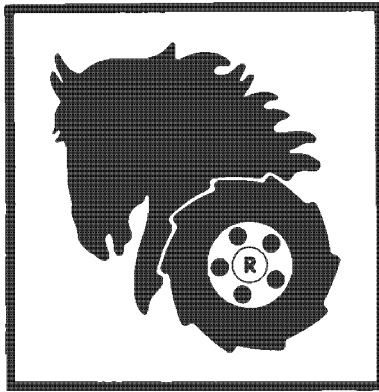

WHEEL HORSE PRODUCTS, INC.

515 West Ireland Road

South Bend, Indiana 46614